

NIKKISO

N series NFH



www.shuneiko.com

NIKKISO EIKO

Solenoid Driven Metering Pump **N series NFH**

The series NFH is a solenoid driven metering with the concept of the user-friendly design. Our technology makes the pump with reliable feeding performance. The feeding capacity can be adjusted via stroke length and stroke frequency to obtain a satisfied turndown ratio.

■ The wide voltage circuit design.
1Ø100V~240V+/10%
It makes the pump can be used everywhere.

■ Safety device for solenoid.
The solenoid with thermostat always makes the pump running safely.

■ The water / dust proof design
Equivalent to protection IP65

■ Easy to read the LCD display
The LCD display shows the operation status clearly.

Manual air vent valve

At the time of start-up, the retained gas in the pump head or suction hose can be expelled by rotating the air vent valve.



PVDF body



360° Rotation

The pump can be rotated on the base through 360°



Stroke length adjusting dial

Stroke length of the pump can be adjusted in a range from 50 to 100% by turning the dial.

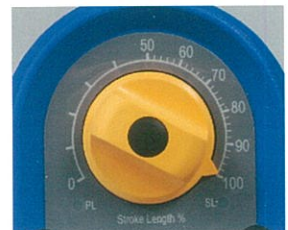

Touch keys



- STOP / START key
- Mode setting key
- LCD indication selected key

LCD display

Flow rate indication (ml/min)
(Use this as a guide, as actual flow rate is not measured.)



Stroke number indication (1-200spm)



% of Stroke number indication (%)



Performance Curves

NFH10

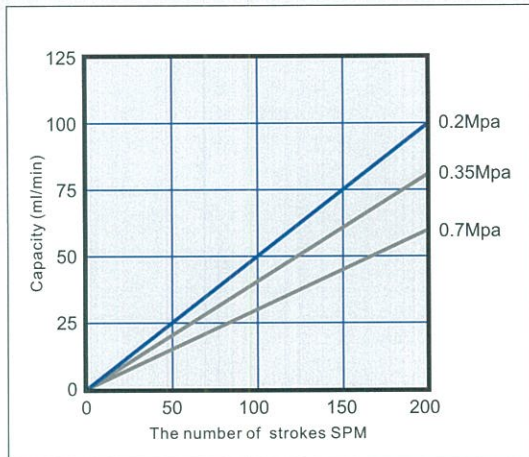

NFH20

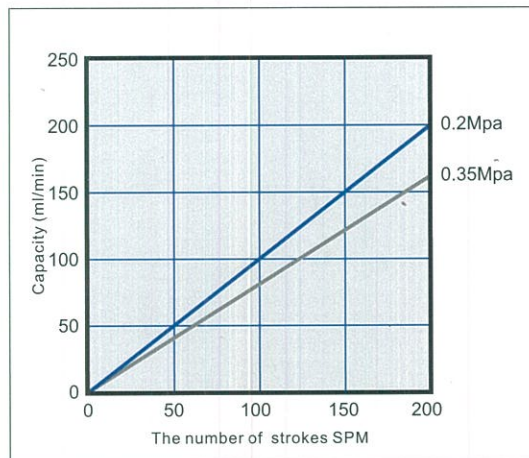

※Performance curves may vary by location and conditions. The flow rate should be adjusted according to flow rate measurements based on use conditions.

Liquid Ends

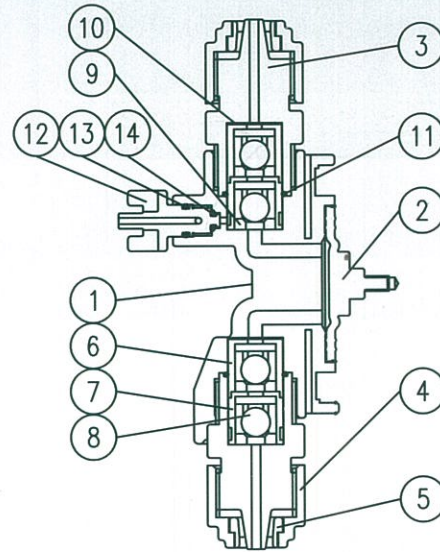

NO	Component name	Material	Q'ty
14	O-ring	FPM / EPDM	1
13	O-ring	FPM / EPDM	1
12	Air vent valve	PVDF	1
11	O-ring	FPM / EPDM	1
10	Gasket	PTFE	2
9	Valve seat	FPM / EPDM	4
8	Ball valve	CE	4
7	Ball guide B	PVDF	2
6	Ball guide A	PVDF	2
5	Union nut collar	PVDF	2
4	Union nut	PVDF	2
3	Hose joint	PVDF	2
2	Diaphragm	PTFE / CR	1
1	Diaphragm head	PVDF	1

Specifications

Pump Model	NFH10	NFH20
Max. Discharge capacity ml/min	100	200
Max. Discharge pressure (Mpa)	0.7	0.35
Connecting hose for suction and discharge	PVC braided hose $\phi 6 \times \phi 11$	
Connecting hose for air vent	PVC hose $\phi 4 \times \phi 6$	
Number of strokes	1 to 200spm digital indication	
Stroke length adjusting range	50~100%	
Power source	50/60Hz AC100~240V $\pm 10\%$	
Max. Current at ON	2.8A	
Average power consumption	30W	
Protecting type	Equivalent to IP65	
Discharge accuracy	Within $\pm 2\%$ (at max. Discharge rate)	

※Install and anti-siphon check valve to observe stable flow from the pump.

Model Code

NF	H	10	P2	MC	CF	SP
①	②	③	④	⑤	⑥	⑦

① Pump Series
NF : NF

② Solenoid Type
H : H

③ Pump Size
10 : 10
20 : 20

④ Diaphragm Head
Material
P2 : PVDF
S2 : SUS316

⑤ Circuit Function
MC : Basic Type

⑥ Material of Valve and O-ring
CF : Ceramic / FPM
CE : Ceramic / EPDM
MF : SUS316 / FPM
ME : SUS316 / EPDM

⑦ Special Indication
None : Standard
SP : Special Specification

Solenoid Driven Metering Pump **N series NFH**

Dimensions

Unit:mm

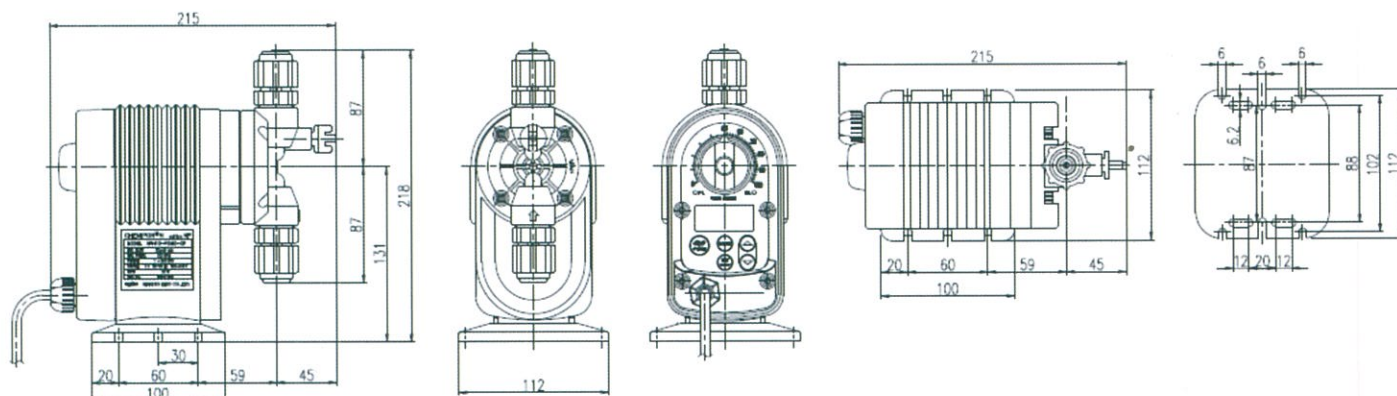

Accessories

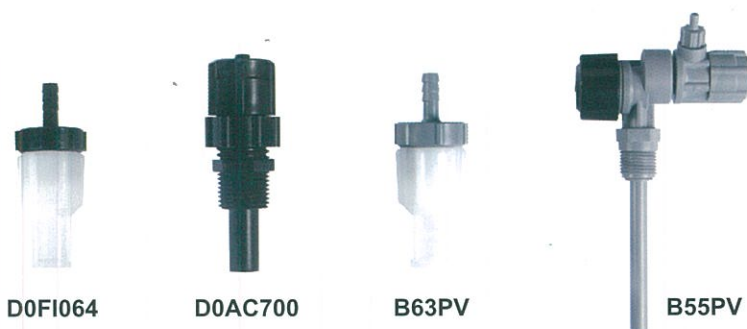

	Name	Model	Applicable Pump
Standard Accessories	Filter	D0AC700	NFH 10~20
	Anti siphon check valve	D0FI064	NFH 10~20
	Suction / Discharge hose	Ø 6 X Ø 11	3 Meter
	Air vent hose	Ø 4 X Ø 6	1 Meter
Optional Accessories	Anti siphon check valve	B55PV	NFH 10~20
	Foot valve	B63PV	NFH 10~20