

## **DUROK 1.5**

**1500 kg.**



- *1st Innovative design ever.*
- *Compact size & light weight, convenient for operation.*
- *Energy-saving & environment-friendly design maximizes running time.*
- *Incredible market share globally.*





**ANTI-VIBRATION TECHNOLOGY FOR BATTERIES:**

- Special anti-vibration technology extends maintenance-free battery life.

**OPERATION:**

- Ergonomically-designed tiller head helps increase efficiency; Internal charger for easy charging.

**INNOVATION**

- 1st Innovative design ever won the REDDOT award.



**reddot design award  
winner 2012**

**CABLES:**

- Robot cables with excellent twist resistance offers longer life span.

**SAFETY:**

- Handy emergency disconnect button & durable driving unit ensure safety under any situation.

**LIGHT WEIGHT, GREAT CAPACITY, GREAT PASSINGABILITY:**

- Light weight & compact size create excellent.
- Maneuverability & passingability.
- 1500KG capacity handles most applications.

**CHARGER:**

- Charger with temperature indicator protects battery.

**SERVICEABILITY:**

- Assembly components, easy for diagnosis and replacing.



## SPECIFICATION

Distinguishing mark				
1.1	Model			DUROK 1.5
1.2	Product code			GTPPS(L)15
1.3	Drive unit			Electrics
1.4	Operator type			Pedestrian
1.5	Rated capacity	Q	kg	1500
1.6	Load center distance	c	mm	600
1.7	Load distance	x	mm	883/946
1.8	Wheelbase	y	mm	1228/1268
Weight				
2.1	Service weight (include battery)		kg	205
2.2	Axle loading, laden driving side/loading side		kg	574/1131
2.3	Axle loading, unladen driving side/loading side		kg	165/40
Types, Chassis				
3.1	Tyre type driving wheels/loading wheels			PU/ PU
3.2	Tyre size, driving wheels (diameter×width)		mm	Φ210×70
3.3	Tyre size, loading wheels (diameter×width)		mm	2x Φ80×60 (Φ74×88)
3.4	Tyre size, caster wheels (diameter×width)		mm	74×88
3.5	Wheels, number driving . caster/loading (x=drive wheels)		mm	1x2/4 (1x 2/2)
3.6	Track width, front,driving side	$b_{10}$	mm	432
3.7	Track width, rear,loading side	$b_{11}$	mm	410 (535)
Dimensions				
4.1	Lift height	$h_3$	mm	115
4.2	Height drawbar in driving position min./max.	$h_{14}$	mm	750/1170
4.3	Lowered height	$h_{13}$	mm	85 (75)
4.4	Overall length	$l_1$	mm	1632
4.5	Length to face of forks	$l_2$	mm	482
4.6	Overall width	$b_7$ / $b_2$	mm	560 (685)
4.7	Fork dimensions	$s$ / $e$ / $l$	mm	50/150/1150
4.8	Distance between fork-arms	$b_5$	mm	560 (685)
4.9	Ground clearance, center of wheelbase	$m_2$	mm	35 (25)
4.10	Aisle width for pallets 1000 × 1200 crossways	$A_{st}$	mm	1739
4.11	Aisle width for pallets 800 × 1200 lengthways	$A_{st}$	mm	1939
4.12	Turning radius	$W_a$	mm	1485
Performance data				
5.1	Travel speed, laden/ unladen	km/ h	km/h	4/4.5
5.2	Lifting speed, laden/ unladen		m/ s	0.022/0.025
5.3	Lowering speed, laden/ unladen		m/ s	0.034/0.023
5.4	Max. gradeability, laden/unladen		%	5/16
5.5	Service brake type			Electromagnetic
Electric-engine				
6.1	Drive motor rating S2 60 min		kW	0.65
6.2	Lift motor rating at S3 15%		kW	0.84
6.3	The maximum allowed size battery		mm	265x185x215
6.4	Battery voltage/nominal capacity K20 (type)		V/Ah	2x12/85 (Maintenance-free)
6.5	Battery weight		kg	2x25.5
Addition data				
7.1	Type of drive control			DC
7.2	Steering type			Mechanical
7.3	Sound pressure level at the driver's ear		dB(A)	74

\* Specifications may change at anytime without prior notice and may also vary in some countries.

# TECHNICAL DATA

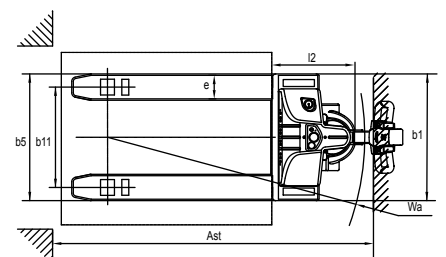
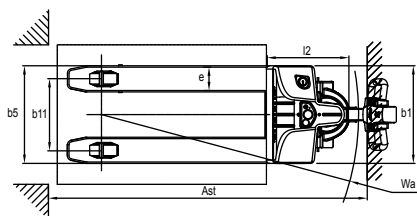
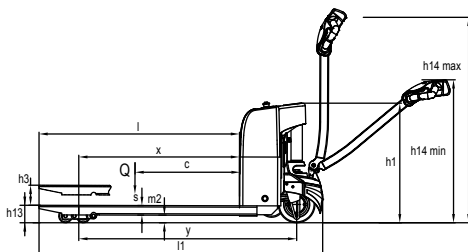

## OPTION

Options	DUROK 1.5
Fork length	○ 700~1500 mm
Fork width	○ 420/460/520/600/635 mm
Single load wheel	○
Fork lowered height	○ 40/60 mm
Driving wheel	○ PU wheel with Pattern
Balance wheel	●
battery indicator with hour meter	○
half speed function in turning	○
Backrest height	○ 1220mm (48in)/1520mm (60in)

Note : ● Standard ○ Option

